

NO.	PART NAME	PART#	REQ'D	MATERIAL
1	EYEBOLT 1/2"X1 3/4"	A19145	2	18-8 SS
2	ANGLE BRACKET	A32580	2	304/316 SS
3	BUSHING	A32629	2	CS Z/P
4	DUAL TORSION SPRING	C32579	1	302 SS
5	HEX BOLT ASSEMBLY 7/8" X 10"	HB70433SA	1	18-8 SS
6	TOP LOCK NUT 1/2"-13	LN70800	2	18-8 SS

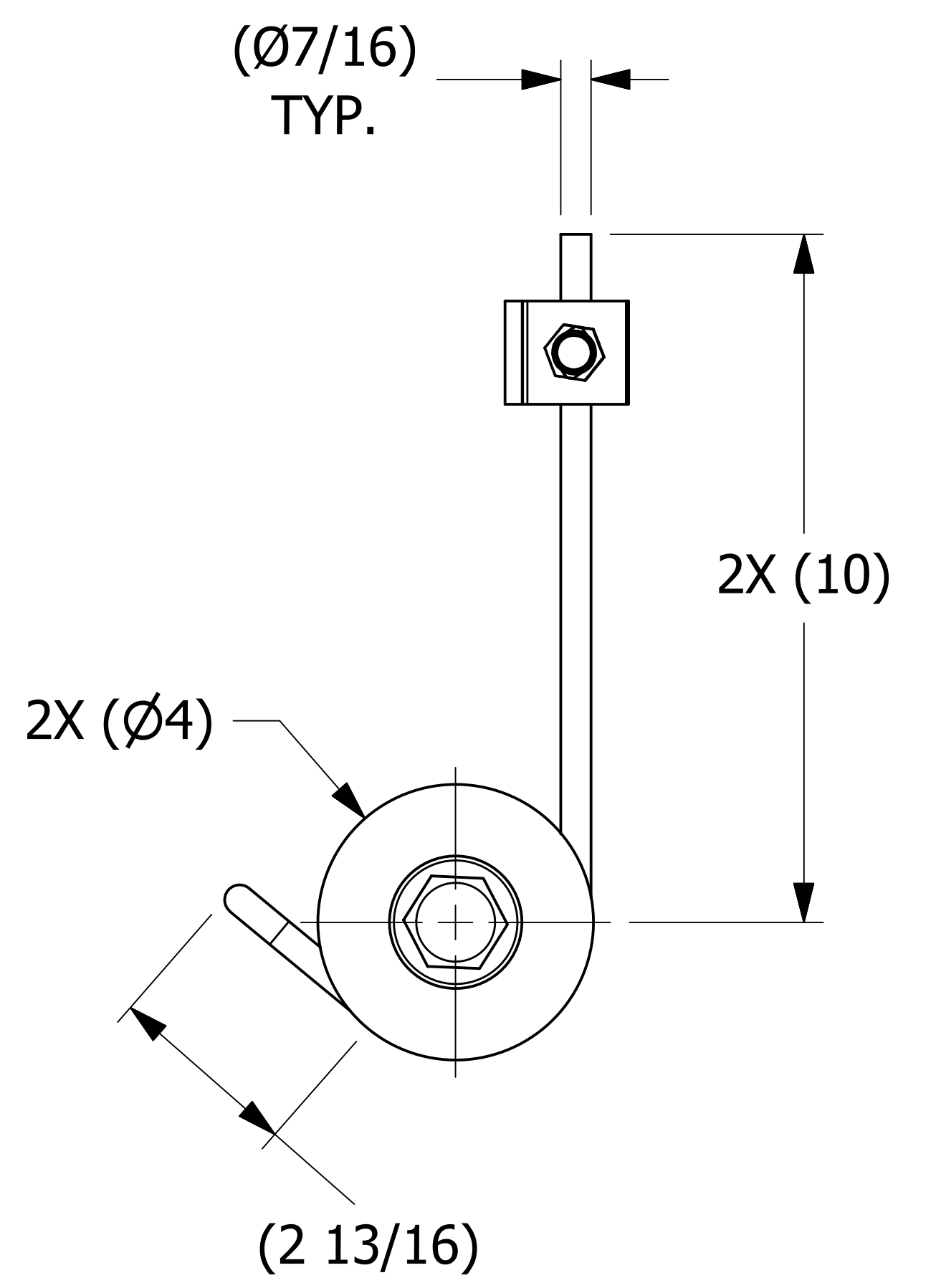
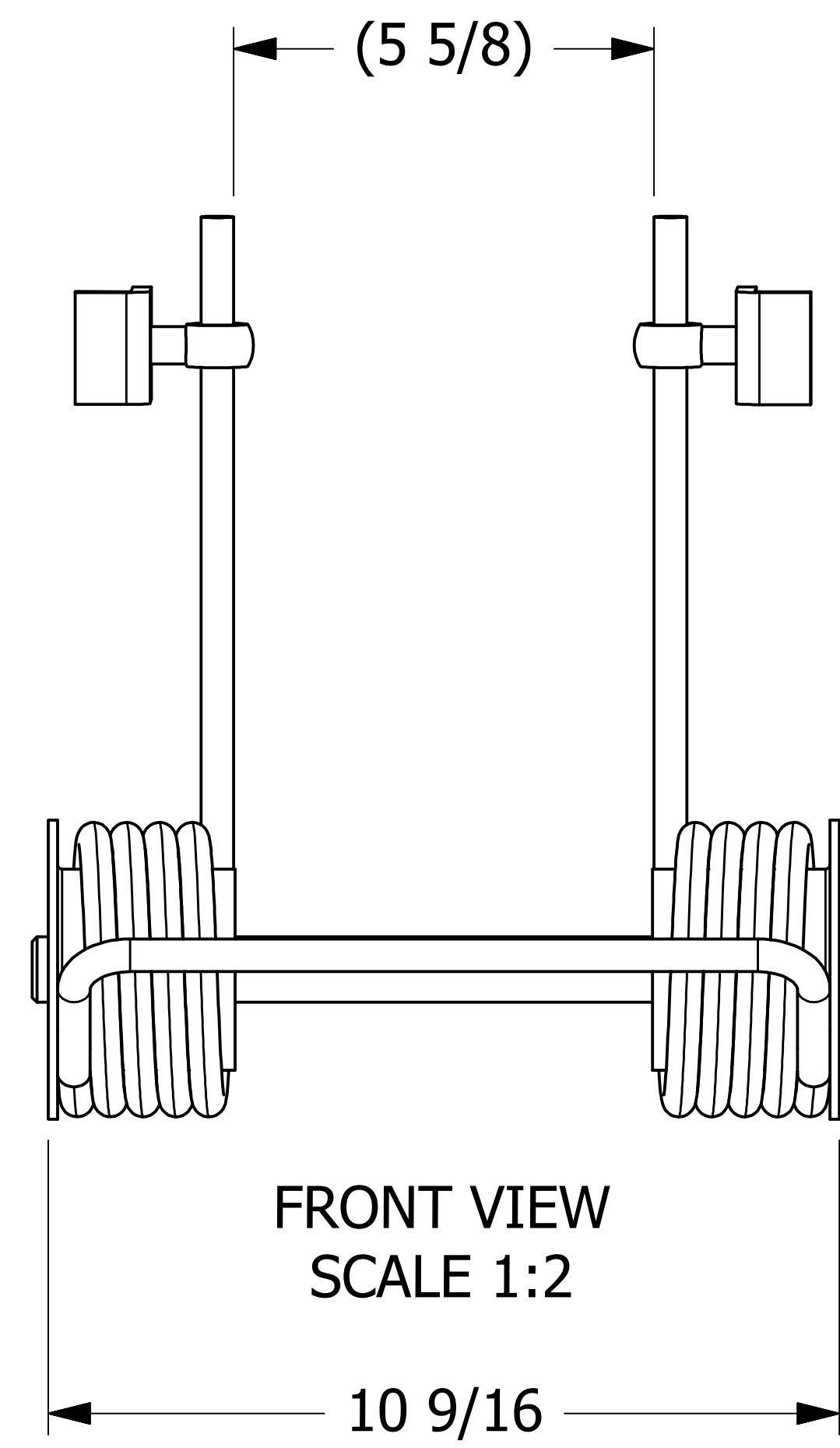
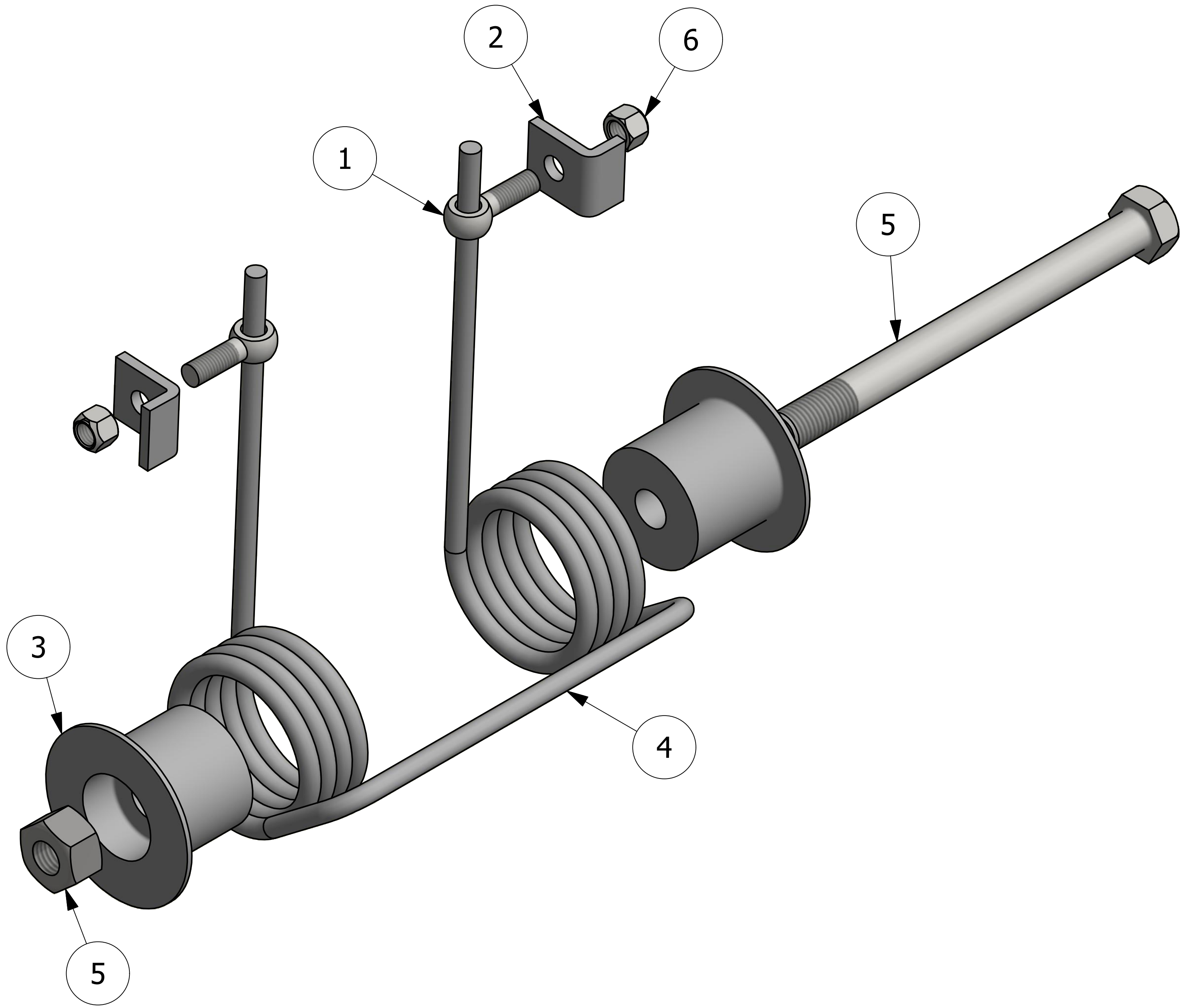

**NOTES:**  
 1. FITS ON TRINITY STYLE COVER.  
 2. APPROX. TORQUE @ 60° DEFLECTION: 175 FT-LBS

C	JG	12-28-18	A32580 WAS A48396
B	JG	12-18-18	A48396 WAS A32580
A	TAK	1-21-14	RELEASED FOR PRODUCTION
REV	BY	DATE	DESCRIPTION

UNLESS OTHERWISE SPECIFIED DIMENSIONAL TOLERANCES FRACTIONAL: ±1/16 X.XX: ±.03 X.XXX: ±.015 ANGULAR: ±1° DEBURR ALL SHARP EDGES. ALL MACHINED SURFACES TO HAVE A 125 RMS FINISH UNLESS NOTED OTHERWISE. THIRD ANGLE PROJECTION	DRAWN BY:	TAJ
	CHECKED BY:	CHL
	PROTOTYPE BY:	TAJ
	PROTOTYPE DATE:	2/29/2012
	APPROVED FOR PRODUCTION BY:	VD
	PRODUCTION DATE:	1/21/2014

**SALCO PRODUCTS, INC.**

**LIFT ASSIST**

MATERIAL: **SEE BOM**

PROJECT #: **120215** SHEET #: **1 OF 1** SCALE: **1:2**

DRAWING #: **D32578** PART #: **LAD20TR2**

THIS PRINT, PROPERTY OF SALCO PRODUCTS INC. CONTAINS PROPRIETARY INFORMATION AND MUST NOT BE COPIED, REPRODUCED, OR USED DETRIMENTALLY TO OUR INTEREST.